

# MASTER LOT MAP WILLIAMSVILLE CEMETERY

MAIN STREET

GLEN AVENUE

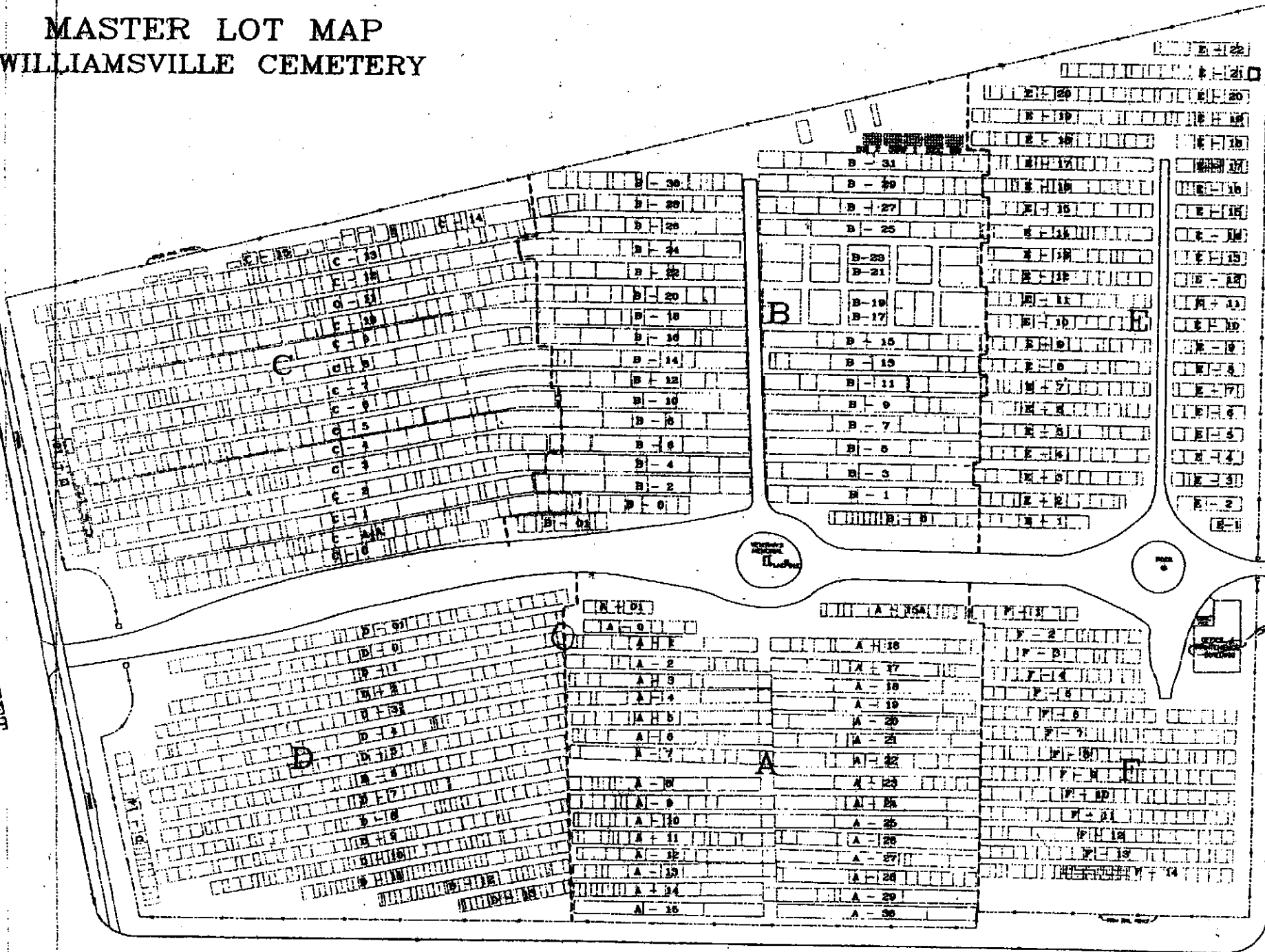

# SECTION A

## WILLIAMSVILLE CEMETERY

### WILLIAMSVILLE, NEW YORK

SONN	RANNET	RUTECKI	BARNES A - 16	DERNICK A - 15A	HOMSER	BERNS DOFF	RUMMELL	RUMMELL	SHERRER	BOWOOD
			TREE		TREE		TREE		TREE	

WALTZ/ ESS	REINMAN/ UNIT	BLOUCH	GELTJUSS A - 16	FAGEN	TAYLOR	LAMPHEAR	LAMPHEAR	RICKERO	MANGANO	OLIVER
---------------	------------------	--------	--------------------	-------	--------	----------	----------	---------	---------	--------

POST DOW	DOLMAN	HORNBER	VASKO	BECKER	STOCKER	BOERSMA	HERSHEY	KLUTE	KRAUS	KRAUS	STANHOPE
-------------	--------	---------	-------	--------	---------	---------	---------	-------	-------	-------	----------

KREHBIEL A - 18	HERSHEY	KLUTE
--------------------	---------	-------

KING A - 19	MILLER	SHERREY DATE STLY
----------------	--------	----------------------

HODVER	NAUGHTON	NACHLEN	NEFF	A - 20	REIST	REIST	ADAMS
--------	----------	---------	------	--------	-------	-------	-------

ROHR	FALAU	SHEASLEY	A - 21	LINTZ	GETZ
------	-------	----------	--------	-------	------

MESS- INGER	CAMPBELL	ABT	TOMPKINS	MANGANO	SIMON	PIETRASZAK	SHRIVER	BHL	CASWELL
----------------	----------	-----	----------	---------	-------	------------	---------	-----	---------

BERTS	MOUTON	BUZASVI	KANT	DEL- BRYCE	A - 23	COLE	BAMBACH	BAMBACH	DEAN	DEAN	SEWERYN
-------	--------	---------	------	---------------	--------	------	---------	---------	------	------	---------

TNEY	HER- SHEY	TSUNG	CHAMOR	BENTON	A - 24	SHISLER	MARTZOLF
------	--------------	-------	--------	--------	--------	---------	----------

LADD	REID	A - 25	SCHUNEMAN	BEACH
------	------	--------	-----------	-------

SMITH	SMITH	FOGELSONGER	A - 26	MILLER	COE	MILLER
-------	-------	-------------	--------	--------	-----	--------

SMITH	HUIVER	A - 27	BRENCH	BICLOW	LENTZ
-------	--------	--------	--------	--------	-------

HERR	KORDEK	MORRETT	A - 28	LANDEL	ERNST	ERNST	SHISLER	CLEARY	SZAGHTA	AMON	AMON
------	--------	---------	--------	--------	-------	-------	---------	--------	---------	------	------

PP	LONG	LONG	LONG	LONG	HERSHEY	BOLMAN	FOGELSONGER
----	------	------	------	------	---------	--------	-------------

LONG	A - 30	LONG
------	--------	------

SECTION A

F - 1	F - 2	F - 3	F - 4	F - 5	F - 6	F - 7	F - 8	F - 9	F - 10	F - 11	F - 12
-------	-------	-------	-------	-------	-------	-------	-------	-------	--------	--------	--------

APPROVED FOR FINAL DESIGN  
AS CORRECTED IN RED

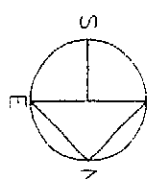

SHEET 2 OF 2

NOTE: THIS SURVEYING WAS SOLELY FOR INFORMATION PURPOSES. THE CENTER POINT RECORD FURNISHED BY THE OWNER AND WARD, INC. DOES NOT GUARANTEE THE ACCURACY OF THE SURVEY. FAMILY NAMES SHOWN ARE RECORDED AS LOT OWNERS. NEEDS ARE Y THOSE INTERESTED RECORD BOOK.

BY \_\_\_\_\_ DATE \_\_\_\_\_  
PLEASE RETURN 1 SET TO GREYER & WARD, INC.  
SCALE: 1" = 10'-0"

REVISIONS  
DRAWN BY: RUF  
5-30-99

GREYER & WARD  
Cemetery Plg  
3802 N. Buffalo  
Orchard Park, NY

# SECTION D



SECTION B  
WILLIAMSVILLE CEMETERY  
WILLIAMSVILLE, NEW YORK

NOTE: THIS MAPING WAS PREPARED SOLELY ON INFORMATION PROVIDED IN THE COPIERS LOT RECORD BOOK, AS FURNISHED BY THE OWNER, GREYER & WARD, INC. THE COPIERS LOT RECORD BOOK IS THE ONLY AUTHORITY FOR THE PLACEMENT OF GRAVES. IT IS THE RESPONSIBILITY OF THE OWNER TO RECORD AS LOT DIMENSIONS NOT NECESSARILY THOSE INTERESTED IN THE RECORD BOOK.

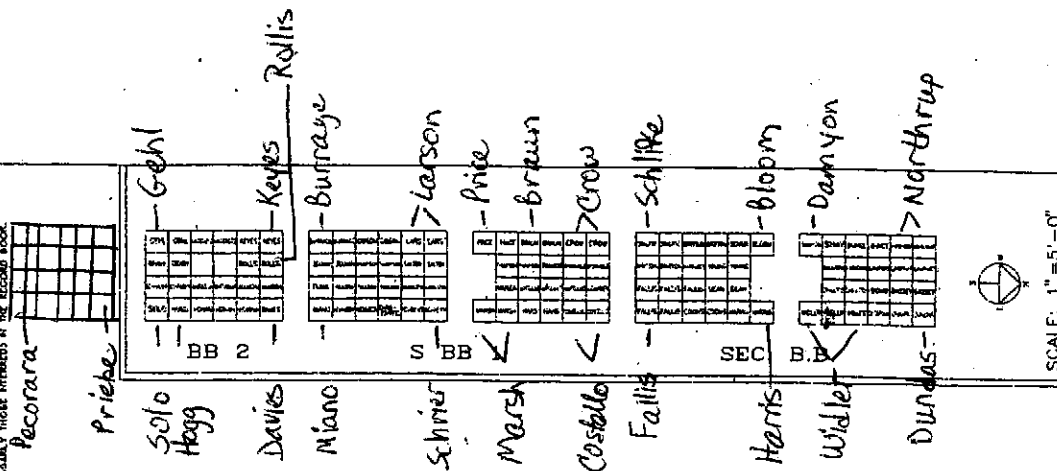

SCALE: 1" = 5'-0"

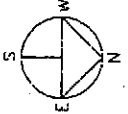

SHEET 3 OF 7

SCALE: 1" = 10'-0"

DESIGNED BY	R.F.	DATE	8-30-81
CHECKED BY	T.M.		
DATE	10/11/81		

GREYER & WARD, INC.  
Cemetery Planning  
3802 N. Buffalo Street  
Orchard Park, N.Y. 14427  
716-662-7700

ROW DESIGNATION ?

LINE DESIGNATION

APPROVED FOR FINAL DESIGN  
AS CORRECTED BY ME  
DATE

PLEASE REVIEW SET BY  
OWNER & FILE FILE

KRESSEL	BAHKE	CHET-SANCER	WVAL	WVAL	JOHNSON	KELLY	STALEY	SWEITZER	SWEITZER	DRAKE	EVANS	WHITE-WHITE	ZUEGE	B - 30
LAME	WALZ	FAST-MARTI	WRR	DATZOLD	YOUNG	KRBE	MOREY	HODIN	WETZELREINHARD	BOR-SCHNE	MAURER			B - 28
KATZMAN	ECHSELBORGER	JEWETT	STALEY	BATES	AREUTZ	ABT	ROGERS	LAURER						B - 26
CRETSINGER	CRETSINGER	WALTER	DOX	JASLAND	TRIST	LANGER	OLBERT							B - 24
MOSSERMAN	SCHWARS	FRANTZ	VOGEL	BROWN/HEAVAR	ELCHMIST	SHESLEY	QUERTHYER	OSTWALD	SHANK					B - 22
WELKER	PANFEL	BLARR	BLOUGH	BLOUGH	STALEY	BLOUGH	BOETTER	WHITE	BEACH	BEACH	REST			B - 20
WYMER	REY	REST	ALLEN	LICH-TERHARD	SPALDING	HENNING/CROFF	WARZDUT	WHITEWHITE						B - 18

LIEE/CAMPBELL	BECKER	ELEY	HANDEL	STENGEL	ZUEGE	KOSSEL-BRECHT	COL-MERKEL	WHITE-WHITE	SENF	MESCH	KRANTZ	VOLA	B - 31
GRAMM	HERR	LONG	FELLER	OSWALD	STERNBRENNER	PERSONNA	SEDER	EISEMAN					B - 29
FIR	SHANK	HOUCK	BENDITZ	VOGEL	SABELLER	POSS	KLUITE	KLUITE	WREDE	DOVKE			B - 27
FERO	BEACH	CHALMERS	OSTWALD	DEAN	COLE	WOLF	WATER						B - 25
JOHNSON	FRES	B - 23	STALEY	GRUHL	JOHNSON								
EVANS	FRES	B - 21	STALEY	GROVE	CRETSINGER								
CROCKER	EGGERI	B - 19	GREEN	GROVE	GROVE								
LORENZ		B - 17	HERR	GROVE	VAN FELT								

SECTION E

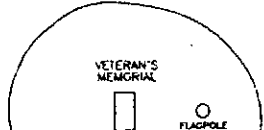
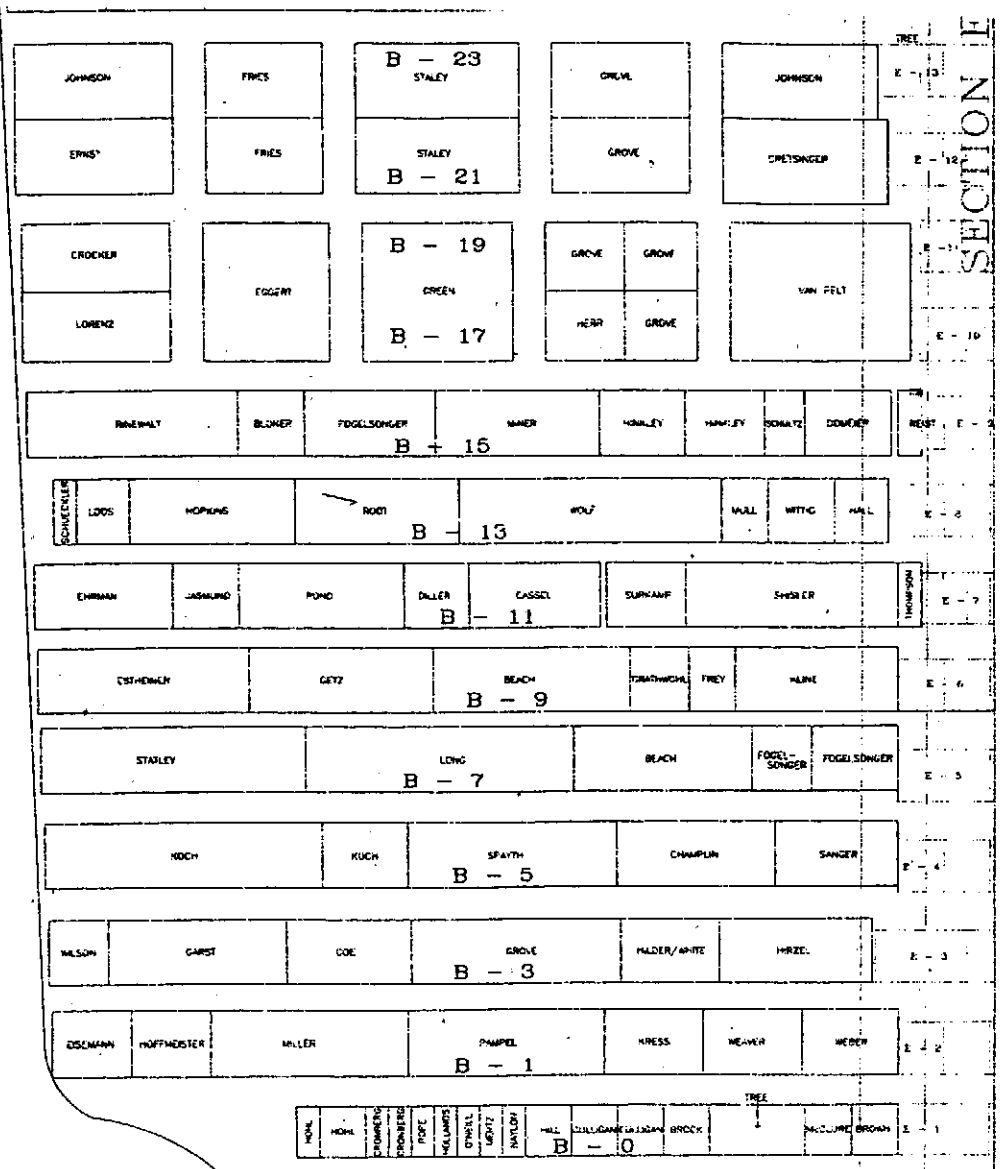
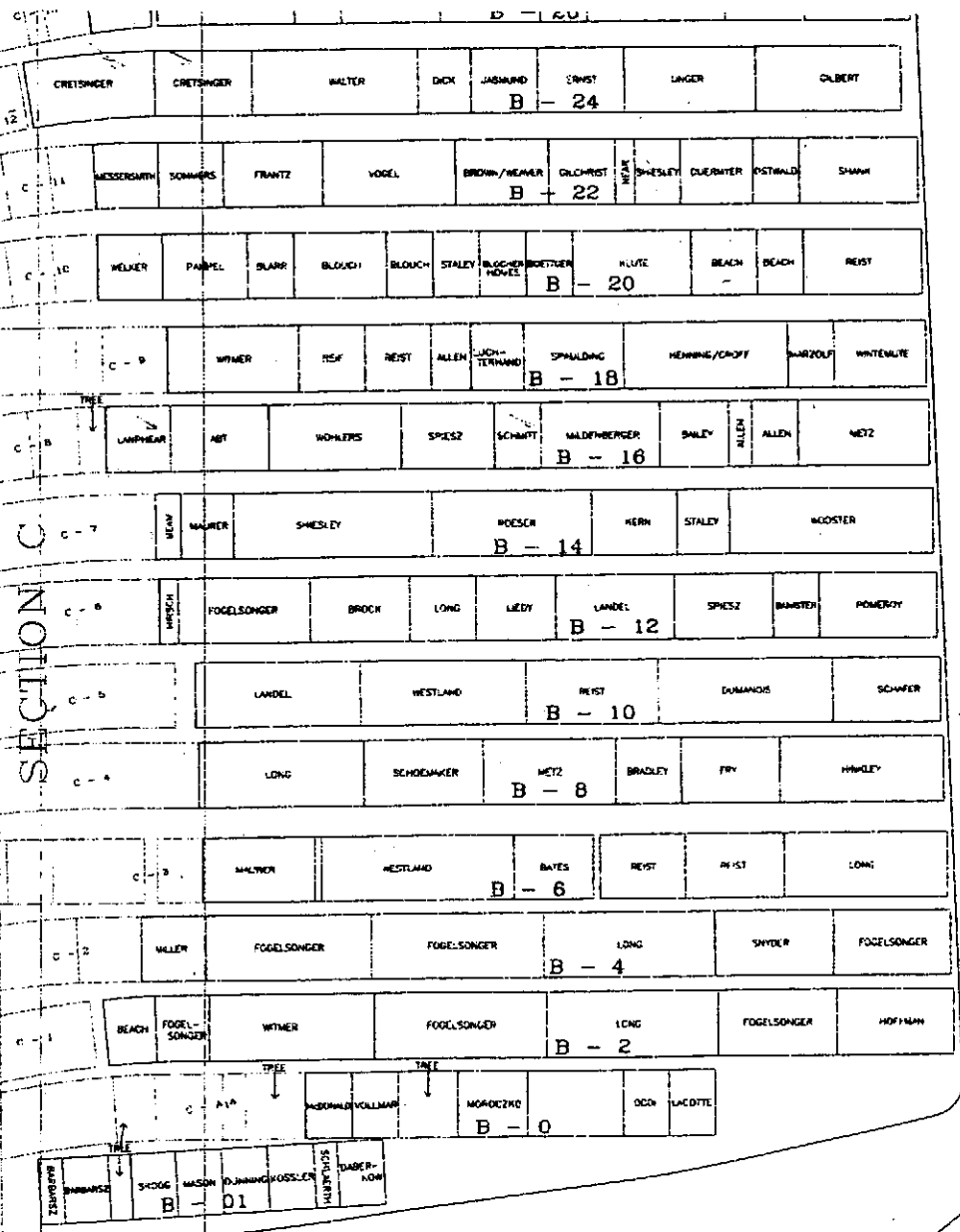

# SECTION C WILLIAMS VILLE CEMETERY

(910 6292008)

\* This is correct.  
C-14 ends on other half  
of Section C map.

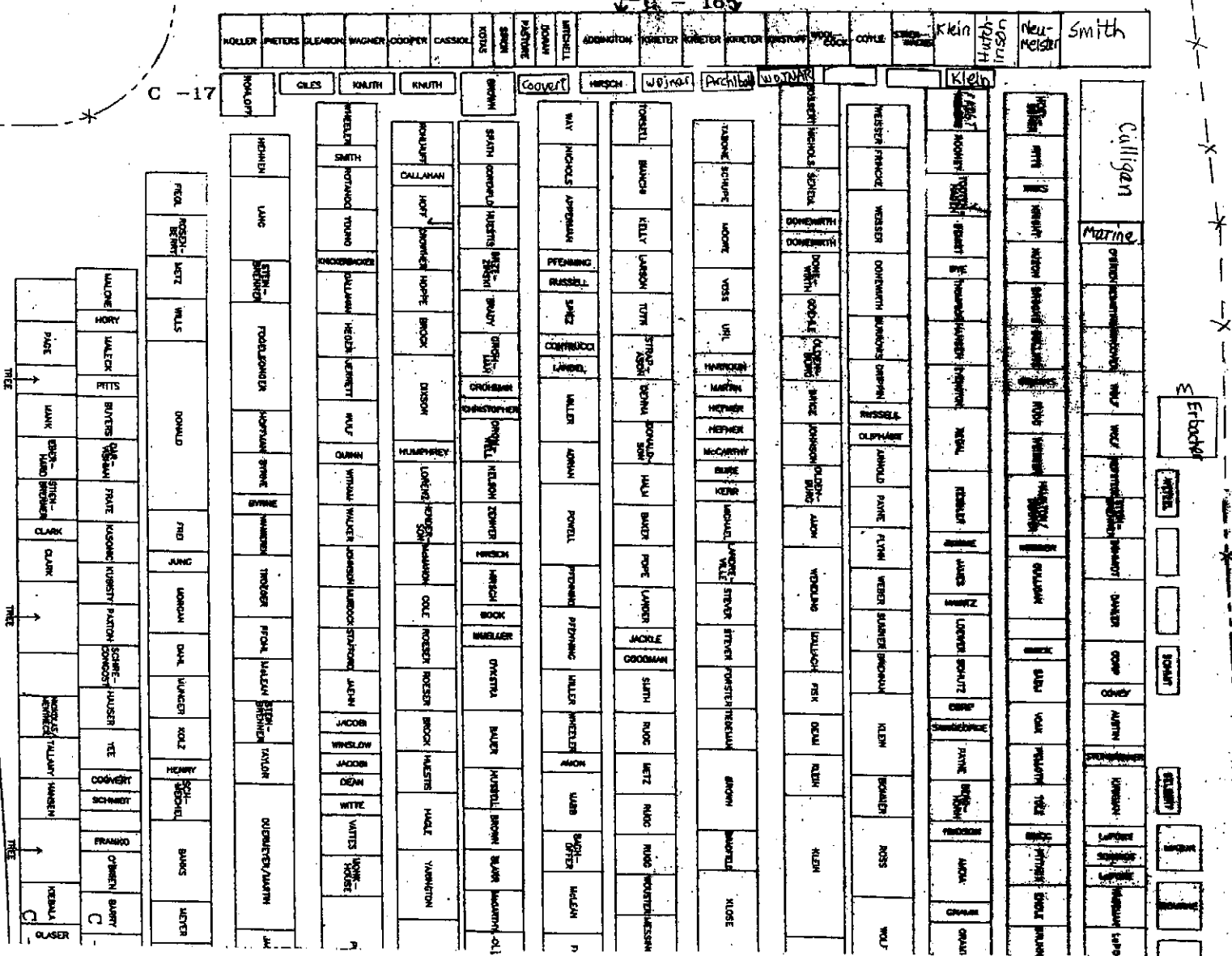

- C-0
- CA-1A
- C-1
- C-2
- C-3
- C-4
- C-5
- C-6
- C-7
- C-8
- C-9
- C-10
- C-11
- C-12
- C-13
- C-15 \*

C-15  
SPACES  
START HERE  
Baby Graves  
C-14

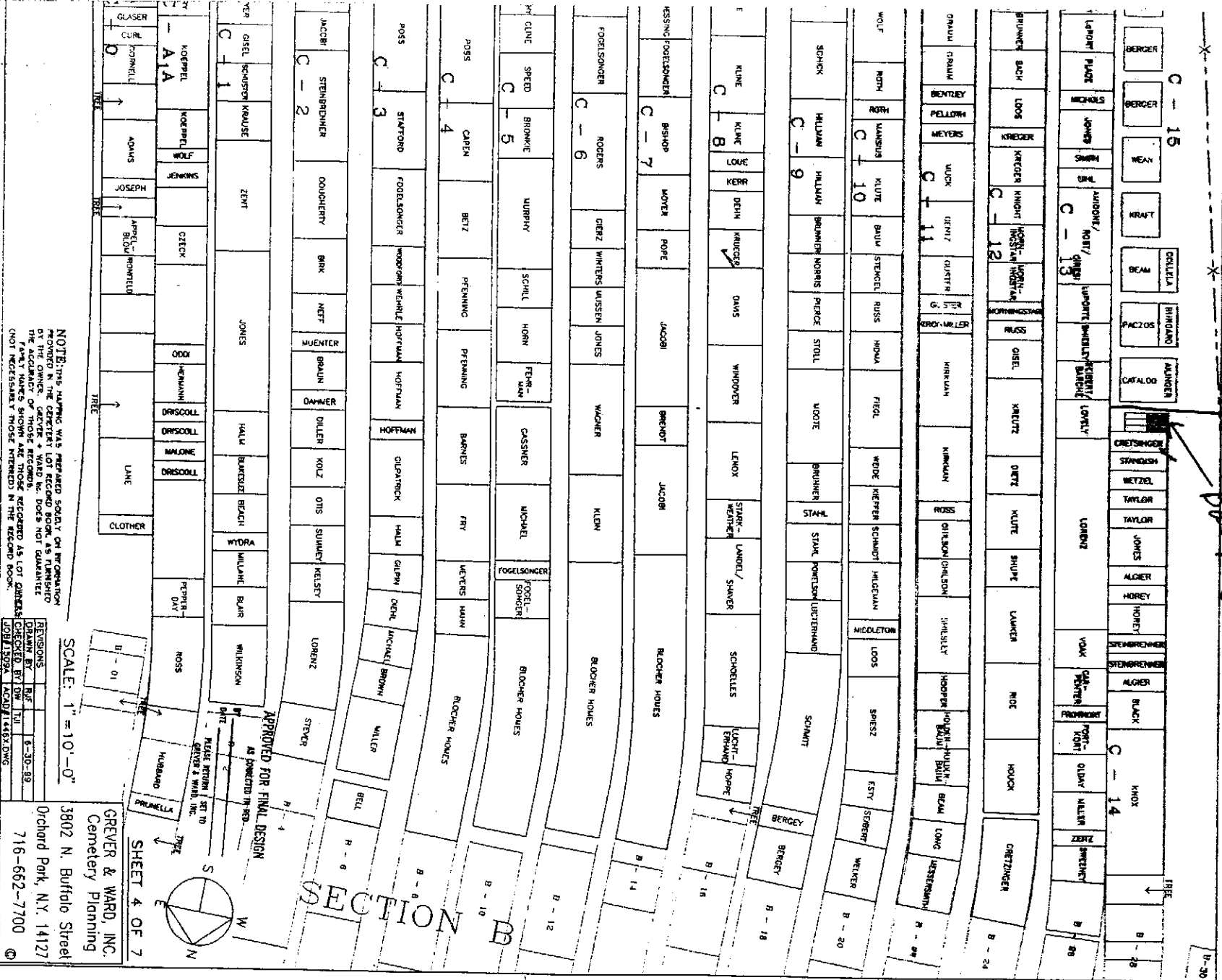

# WILLIAMSVILLE CEMETERY WILLIAMSVILLE, NEW YORK

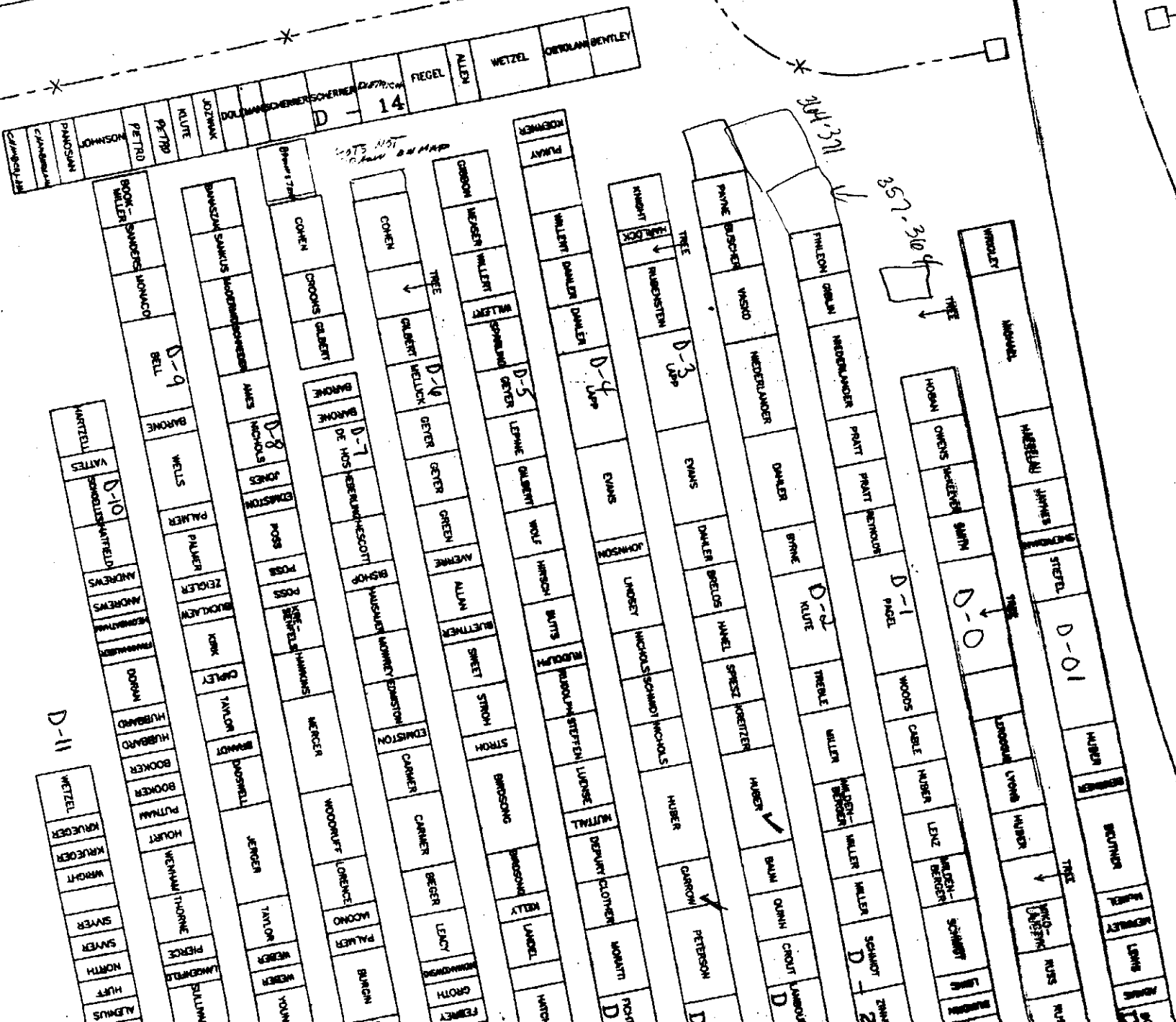

**NOTE:** THIS MAP WAS PREPARED SOLELY ON INFORMATION PROVIDED IN THE CEMETERY LOT RECORD BOOK AS FURNISHED BY THE OWNER, CEMETERY + WARD INC. DOES NOT GUARANTEE THE ACCURACY OF THOSE RECORDS. FAMILY NAMES SHOWN ARE THOSE RECORDED AS LOT OWNERS. NOT NECESSARILY THOSE INTERRED IN THE RECORD BOOK.

CANTON





SECTION

B-21 OFFNEY BRE ROBERTSON MURPHY KOZ MILLINGER LITZ SUMS CRO BARBER WICKS HOPPE NELSON SHRE WISE MILLER TROUP  
E - 12

B-19 KIRK CRAWFORD OLIN MONTASO MACHAMON WESBECK FRASER FESSARD BELL CURRIE BLANCHARD TOMM MADDE  
E - 11

B-17 SCHILL HILL SCHMITT WILLIAMS RUSSELL LINDOW WILLIAMS HANFT SDPER LINDOW KUBORA WOLTERS WILLIAMS BARRIE  
E - 10

B - 15 REIST PECK FINK OSWALD OSWALD LYDON HUBERT MCLERNON FIDDLER SMITH COPELLA HILL HILL HAUBIEL MAC-PHERSON MASON CONRY  
E - 9

B - 13 HUCK HUCK CONWAY FULLER-WIDER HOLY-WARTH MAC-MCDOLL WEAVER MAC-PHERSON MAC-PHERSON FREDMAN COURTNEY AUSTIN McVITIE  
E - 8

B - 11 THOMPSON BRINK GOLDEN BARNES STILAS JAMES ROGERS BOURNE SCHEFFLER ROGERS WORDEN RALPH ROBINSON LANE KNAPP STANLEY BOURNE  
E - 7

B - 9 KLINC ABEL THORNE BARRIE ROGERS KERN DIDD-MENICO MILLER ZELMAN BRENNAN JESALL HARLEY COTHAMIN FIEDEL NELSON JANNESSE  
E - 6

B - 7 LIME JENZEN MURRAY BRACH HENRY RUBINS SCHULTZ WANNANUS HILDOR CLIFFORD WOOD-BURN MEYERS DOCKLE  
E - 5

B - 5 LYON MICHAELSON AKER BRAND RILEY CENTER NEWBOLD BUHLER BURNHAM MC-LAUGHLIN FOREST JOHNST NELSON  
E - 4

B - 3 LAMEN-BERGER REAMS MERY MONK MAGRUM SCHMETER O'NEILL BANASZ WHEATON HOHENSTEIN JONES MCINTYRE MAYLOTT HITMAN CAISER  
E - 3

B - 1 HERRMAN HALL SUOR FARBER HERZOG BISS MURRAY GOHR STOCK-WELL FITZ-PATRICK BUTERA BUTERA BUTERA  
E - 2

B - 0 KIDNEY BERMAN BOONE MAGRUM FARBEN-SCHWARTZ LENZNER FARBEN  
E - 1

FARRELL WILKINSON STRICKLAND MC-NAMARA SCHIRK  
E - 12

WILKINSON WILKINSON KIRKAD BURNS SMITH KAPSAR  
E - 11

REES WHEATON KERN MORROW MAYO JAMES WORTHY WATKINS  
E - 10

O'CONNELL WILLS WILSON SMITH McGEE KOLB  
E - 9

DOANE HAAS ATEN WILCOX GREEN HANEL  
E - 8

HERMAN NAUMAN MACQUEEN MANNES TREN-BERTH HERMANN  
E - 7

MAC-ANDER SPUR-BACK IDZAK HUDSON HUDSON SPARROW  
E - 6

SCHWE-LIGEL SCHOSER FARHAM FULLER CALFMAN SWIFT  
E - 5

FEIL WESTPHAL MELDIER BARTON CARR  
E - 4

WARFURT HARBCHT HINDICHT DEMOS SIMPSON WAHL HUCHES  
E - 3

HERMAN PLUCKER DAHLER TRUILL  
E - 2

BAILY ROGERS  
E - 1

GLEN A

210 1-16-2002

SECTION E  
WILLIAMSVILLE CEMETERY  
WILLIAMSVILLE, NEW YORK

NOTE: THIS PLANNING WAS PREPARED  
BASED ON INFORMATION RECEIVED IN  
THE PROPERTY LOT RECORD BOOK AS  
FURNISHED BY THE OWNER. BEFORE  
ANY WORK IS DONE THE OWNER SHOULD  
VERIFY THAT ALL NAMES AND PLACES  
AGREED AS A LOT OWNER. ONE SHOULD  
NECESSARILY THEIR INTERESTS IN THE  
RECORD BOOK.

BOYER	BLACH	HOLT
MOTZ	MITCHELL	SHEN
DORN	STRESSING	
BALUN	ROMER	LIN
FLORENT		SHREVE
		HARRIS
ADZIAN	LARTER	
DAVIS	HONEY	

CREMAINS  
E - 17  
SCALE: 1" = 10'-0"

\*(ENLARGEMENT)

B-21	OTTNEY	BRENE	WINDY	YOUNG	KOTZAN	HILLINGER	LITZ	STRICKLAND	GROSS	BARBER	HICKS	HOPPE	NELSON	SWENSH	WISE	MILLER	TROUP		
B-20	CHAMBERS, SMITH AND BELLECK	PRICE	WOOD	LITZ	POPPER	BAR	SANDERSON	DILCHRIST	STRONG	KLEIN	WELLER								
B-19	WINTER	CHAMBERS, SMITH AND BELLECK	MAHER	O'LEARY	TAYLOR	KLING-BEL	SCHNEIDER	SEDL	SEDL	HEFF	AIKEN	WOLF	POPPER						
B-18	BECKER	METZ	UFTT	NASSEL	ADDAMAN	LUNDOUST	E-15	BOWERY	MAUSER	ANDREWS	COE	McBRIDE							
B-17	HENWEL	LARSON	ASHER	QUINN	SZELL	RAMY	SPRANGE	HAGELMAN	LUCE	MOSE	LEBEL	BRUTTS	SCHWABT	ELY	WINGER	STOCK	TANNER	NUCENT	ZITTEL
B-16	MARVIN	MARVIN	DAVIS	BYRNE	McLELLAN	McLELLAN	FRUEHAUT	HUTCHINSON	ROBINSON	SCHMIDTAL	SAGER	MAZ	GUENTHER	NOBLE	YOUNG	DENK	TERIAN	FRYER	

THOMSON	McLELLAN	McLELLAN	NELSEY	DAVIS	BOHN	E-18	THOMSON	SAUER	WRIGLEY	FISCHER	FISCHER	STOUT	LOVERING	STINDER	STITZ-INGER	SAELI	BOHN
---------	----------	----------	--------	-------	------	------	---------	-------	---------	---------	---------	-------	----------	---------	-------------	-------	------

BOUL	GUDEN	FLIMING	PINKERT	FENZEL	ZIEHER	CORLES	BHR	BURCHDUFT	WILSON	CAMPMAN	KENYON	HOERNER	BETZER	BARBER	McOSKER	ADRIAN	POSS	GRAVELLE	TOBER	MURPHY	DEKLENE	SCHUL	SCHUL
------	-------	---------	---------	--------	--------	--------	-----	-----------	--------	---------	--------	---------	--------	--------	---------	--------	------	----------	-------	--------	---------	-------	-------

ADAMS	STONER	STONER	GARVY	EMRES	O'DONN	PENNAN	HICKEL	FRANK	McKE	BOURNE	McKENNA	DOWNING	SCHREIN	KRESS	FORRIS	BECKER	LONG	PEACOCK	LACOE	LAFFERTY	FIDLER	GRANPP
-------	--------	--------	-------	-------	--------	--------	--------	-------	------	--------	---------	---------	---------	-------	--------	--------	------	---------	-------	----------	--------	--------

O'DONNELL	SPRAGUE	SCHUTZ	PRISON	HARDING	HARDING	HARDING	CHRIST-ANSEN	BRINER	LUOMIC	SNIDER	COUGHAL	FETTO	EBERT	HLEBOL	SINON	SCHUTZ	O'HEARN
-----------	---------	--------	--------	---------	---------	---------	--------------	--------	--------	--------	---------	-------	-------	--------	-------	--------	---------

LANNON	SOULE	OBERNAUER	E-22	LEWIS	EDMISTON	DAVIS	DENZ
--------	-------	-----------	------	-------	----------	-------	------

HALL	NEES	JANSEN	JANSEN	JENNINGS	CARRISON
------	------	--------	--------	----------	----------

KOHLERPP	CARREY	VALUGHAN	ADAMS	ADAMS
----------	--------	----------	-------	-------

REDDING	REDDING	STINER	EDDY	PHILIPS	PRESTON	CORTI	BLAKE
---------	---------	--------	------	---------	---------	-------	-------

GRIFEN	STELLOW	PERCE	HEALER	BEALR	ANDERSON	DEHLER
--------	---------	-------	--------	-------	----------	--------

CUTLER	ROWE	WEATHERBEE	STEINER	ZAGST	SCHULTZ
--------	------	------------	---------	-------	---------

WEIMER	JENNINGS	LAPP	COLLIAN	GUENTHER	DEM
--------	----------	------	---------	----------	-----

FARRELL	STRICKLAND	SCHULTZ
---------	------------	---------

9C-1-5G

21 ← 10-5G

38 ← 22-5G

56 ← 39-5G

\*73 ← 57-5G

SHEET 6 OF 7

APPROVED FOR FINAL DESIGN  
DATE: \_\_\_\_\_

PLEASE RETURN 1 SET TO  
GREY & WARD, INC.

SCALE: 1" = 10'-0"

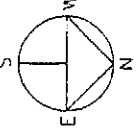

REVISIONS	DATE	BY	DESCRIPTION
1	1-16-2002	JW	ISSUE FOR PERMITS

GREY & WARD, INC.  
Cemetery Planning  
3802 N. Buffalo Street  
Orchard Park, N.Y. 14127  
716-662-7700

AVENUE

A - 21

SECTION A

BURNS	THEMAN	AND	AND	MISCHALL	SWISS	BANE	BAER	MORAN	SCHWEIGEL	WELLS	BENNETT	JACOB	HOEY	HOEY	BURNS	LUND	WEBER	GREENER	PITTS	KADER	HORNER	KADER	ZIMMERMAN	ZIMMERMAN
-------	--------	-----	-----	----------	-------	------	------	-------	-----------	-------	---------	-------	------	------	-------	------	-------	---------	-------	-------	--------	-------	-----------	-----------

A - 22

DOUGLASS	SHELDON	FRANZ	REISNER	WILKINSON	BROWN	GOERGEN	LESAGE	EIMER	GOERGEN	MOSES	MOSES	JOHNSON	BRENNAN	GALLAGER	MCCANN	TROY	CRAPSI	ROBINSON	JOZWAK	JOHNSTON	ANDERSON
----------	---------	-------	---------	-----------	-------	---------	--------	-------	---------	-------	-------	---------	---------	----------	--------	------	--------	----------	--------	----------	----------

A - 23

LANG	HOMANES	SAPECKY	GARE	HARVEY	EDWARDS	ULRICH	STILLWELL	MCDONNELL	ALTON	THEEL	EVANSON	WITCOMB	THOMPSON	BROWN	FRENCH	CULLEN	GENTZ	HENKEL	LYONS	JOHN-DREW	ELSA-ESSER	BURNS
------	---------	---------	------	--------	---------	--------	-----------	-----------	-------	-------	---------	---------	----------	-------	--------	--------	-------	--------	-------	-----------	------------	-------

A - 24

DANFORTH	CHILLES	CONEL	MENISLEY	HECKMANN	NOUNAN	MCMAMARA	LAWRENCE	CHIMERA	ARONICA	LOGAN	SHIPSTON	LUTOMSKI	RUBEN	HUEBER	MANZELLA	FISCHER	ROOP	BART	GULAS	HENNING
----------	---------	-------	----------	----------	--------	----------	----------	---------	---------	-------	----------	----------	-------	--------	----------	---------	------	------	-------	---------

A - 25

PECK	ALLEN	FIBER	BEHMER	HOLBROOK	MCMAMARA	RICH	GLEASON	BLAS-ZKOWIAK	BELAIR	GROTKE	PASS-MORE	CHEDRON	SPENCER	VAN HORN	YUNG-BLUTH	OLSON	DOMROES	SEWERYN	ULLRICH	MCDONNELL
------	-------	-------	--------	----------	----------	------	---------	--------------	--------	--------	-----------	---------	---------	----------	------------	-------	---------	---------	---------	-----------

A - 26

KARI	PEREZ-BODE	MILD-BROOK	HEWELL	FELLER	BURDIGN	HANSEN	WILCOCKS	VAN HOOVER	HOCK	SCHMHL	WAY	DILEO	SCHOHN	SCHOHN	HIRSCH	ANSCOMBE	PALANO	ENS-MINGER	PALMER	FABRIZIO	GUY
------	------------	------------	--------	--------	---------	--------	----------	------------	------	--------	-----	-------	--------	--------	--------	----------	--------	------------	--------	----------	-----

A - 27

MERRILL	FISHBURN	FAYLANGE	BINGW	JACOBS	MEREDITH	GOLDRING	COREN-FLO	FAYLINGER	WILSON	WILSON	WILSON	WILSON	WILSON	MIRANDA	MIRANDA	MIRANDA	BLOCHER	MERRILL	COLEMAN	KANE	DEWEY
---------	----------	----------	-------	--------	----------	----------	-----------	-----------	--------	--------	--------	--------	--------	---------	---------	---------	---------	---------	---------	------	-------

A - 28

A - 29

A - 30

ENTRANCE

REST STREET

METRIDO	COLE	CLARK	HEGGS	WINFIELD	PAINTER	BOYD	REISTER	CALMAN	HAMILTON	PETRE	SERIO	HOUSE
MEDGES	ALESTY	GRADY	MARINE	WOLKE	BRENE	PASS-MORE	COLARUSSO	TUNISON	DAMPWELL	KAEPPEL	SON-LOUIS	WILSON
BAHLER	HILLS	PARKS	ORANDELL	WILSON	WILSON	WILSON	WILSON	WILSON	WILSON	WILSON	WILSON	WILSON
WELMAN	GREAT-HOUSE	SERIO	HOUSE	WELMAN	GREAT-HOUSE	SERIO	HOUSE	WELMAN	GREAT-HOUSE	SERIO	HOUSE	WELMAN



CREMANS F - 14 SCALE: 1"=5'-0"

# SECTION F WILLIAMSVILLE CEMETERY WILLIAMSVILLE, NEW YORK



SOFA	BROWN	WINDT	MUTZ	PRIVIERA	SPAR-SHOTT	CARR	HUGHES	GLATT
------	-------	-------	------	----------	------------	------	--------	-------

ESPIG	SALSBURN	LEISING	FISCHER	KINNEY	WHEELER	WYTHEP	NICHOLS	DAVIS	MAUGANS	BOLZ	CHRIS-HAY
-------	----------	---------	---------	--------	---------	--------	---------	-------	---------	------	-----------

WHARFF	LEINERT	WALTER	LEISING	GERHARDT	ROSA-MILIA	ER-SKILL	LOWERY	FIEDEL	FIEGEL	STARKS	SMITH
--------	---------	--------	---------	----------	------------	----------	--------	--------	--------	--------	-------

LYALL	BARBER	BROWN	BROWN	HOCH-MUTH	GEBHARDT	GEBHARDT	SMITH	INGRUE	GREGG	EAST	KUNDRAI	VASKO	FELDT
-------	--------	-------	-------	-----------	----------	----------	-------	--------	-------	------	---------	-------	-------

WOOD	DAEM	ZACHEAR	ROSS	FLYNN	WEISS	GLENN	DAVIS	VOGALSKI	YODER	WEATHER	WITNAUER	BALM-GARTNER	HORGAN
------	------	---------	------	-------	-------	-------	-------	----------	-------	---------	----------	--------------	--------

HERR-MANN	WOOD-CRICK	WONG-ELEMAN	CLARK	MCCLELLAN	SAND-RETTO	ELLIS	AMBROSO	SMITH	GEBHARDT	MARTIN	PERGVAL	HARTMAN	BAK	ACHRY
-----------	------------	-------------	-------	-----------	------------	-------	---------	-------	----------	--------	---------	---------	-----	-------

MCMEH-AMN	ENG-WANER	CLAY	DOTZOUR	MARTIN	FOX	ATEA	HOKAN	STARKE	GERWIC	BYRNES	RETCH-LESS	LUTOWSKI	KUBISTY	KE-DE	HARTMAN	MUCH-ERNO	FRONHAUER	FISCHER	BURRIS	WYDRO	DEHMLER	DEMLER	PIOTRO-WSKI
-----------	-----------	------	---------	--------	-----	------	-------	--------	--------	--------	------------	----------	---------	-------	---------	-----------	-----------	---------	--------	-------	---------	--------	-------------

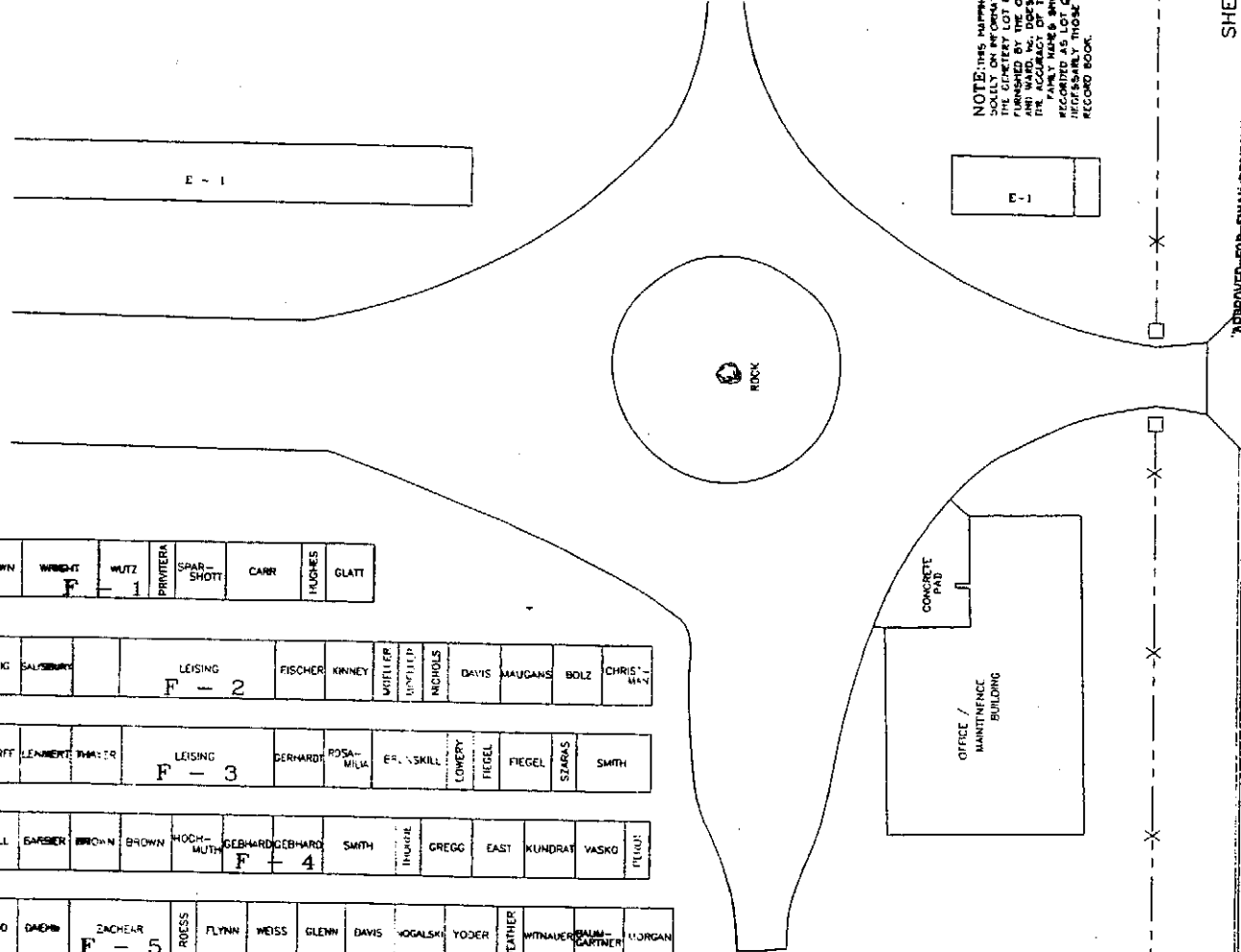

NOTE: THIS MAPPING WAS PREPARED SOLELY ON THE OPERATION PROVIDED IN THE RECORD BOOK. IT IS NOT TO BE USED AS A BASIS FOR ANY ACTION BY ANY PARTY. THE ACCURACY OF THESE RECORDS IS NOT GUARANTEED BY THE ENGINEER. ANY CHANGES TO THESE RECORDS MUST BE RECORDED AS SUCH. OTHERWISE, THE ENGINEER WILL NOT BE RESPONSIBLE FOR ANY ERRORS OR OMISSIONS.

SHEET 7 OF 7

APPROVED FOR FINAL DESIGN  
AS COLLECTED IN RECORD BOOK

BY \_\_\_\_\_ DATE \_\_\_\_\_  
PLEASE RETURN TO SET TO  
SCALE: 1" = 10'-0"

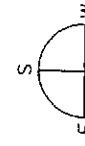

GREVER & WARD, INC.  
Cemetery Planning  
3802 N. Buffalo Street  
Orchard Park, N.Y. 14127  
716-662-7700

REVISIONS	DATE	BY	DESCRIPTION

GLEN AVENUE

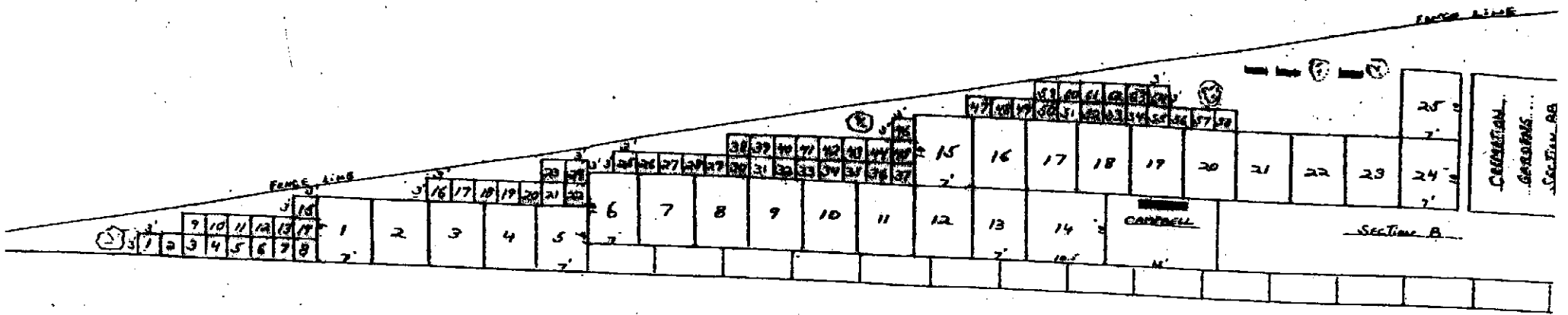

WILLIAMSVILLE CEMETERY - SECTION G

10/200 *[Signature]*

→ NORTH

# MAIN STREET

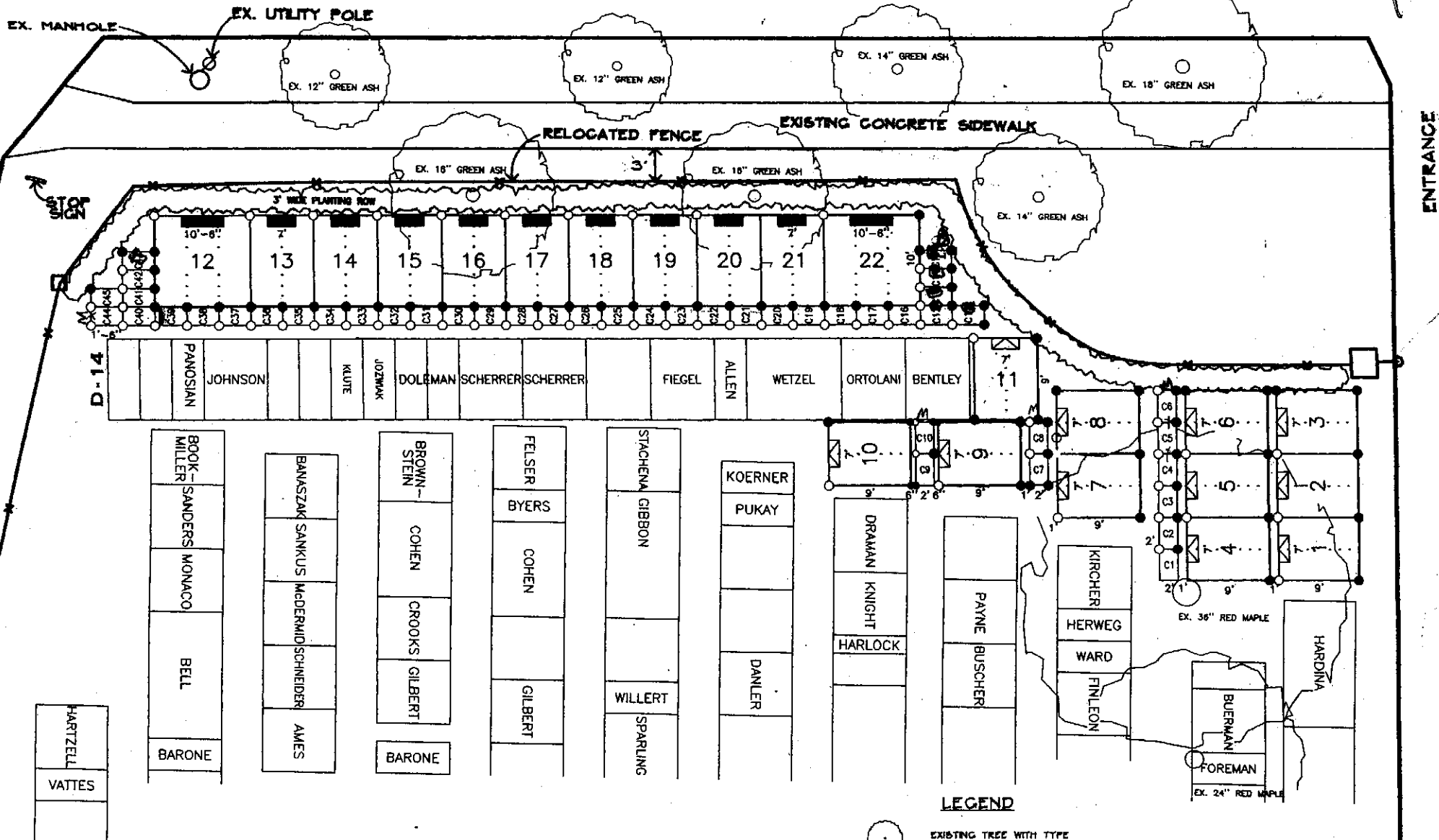

## SECTION H SALES MAP MAIN STREET FRONTAGE WILLIAMSVILLE CEMETERY WILLIAMSVILLE, NEW YORK

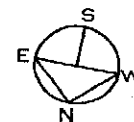
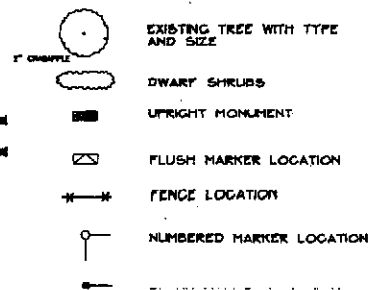

SCALE: 1"=15'-0"

REVISIONS	DATE	BY
SCB08-07-07 NEW FENCE		
MAS	8-12-07	
LJB	8-28-08	
SCB	9-16-08	
MAS	9-20-08	
MAS	11-17-08	

CEMETERY PLANNING  
3802 N. BUFFALO STREET  
ORCHARD PARK, N.Y. 14127

**LEGEND**

- EXISTING TREE WITH TYPE AND SIZE
- DWARF SHRUBS
- UPRIGHT MONUMENT
- FLUSH MARKER LOCATION
- FENCE LOCATION
- NUMBERED MARKER LOCATION
- BLANK MARKER LOCATION

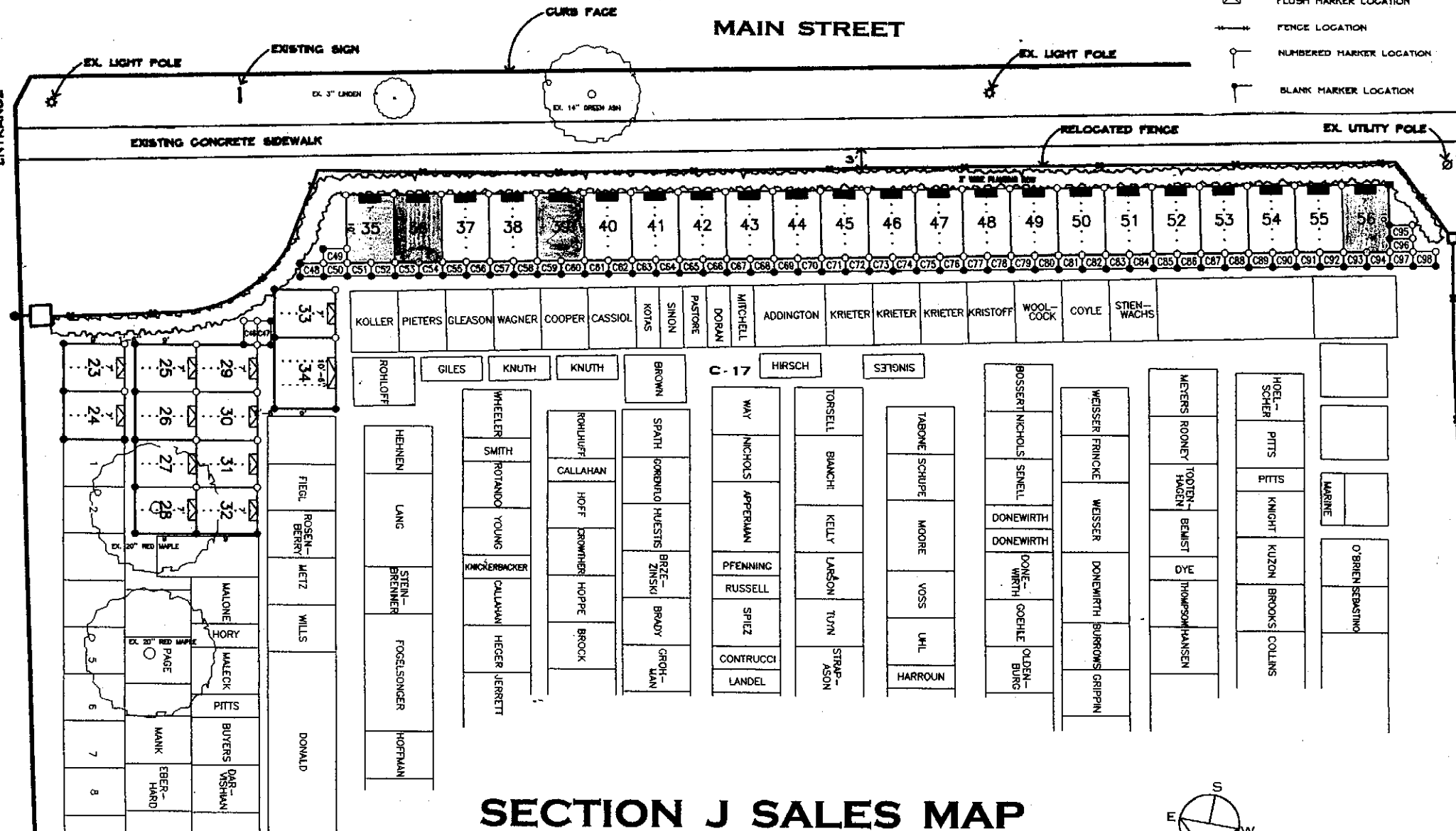

**SECTION J SALES MAP  
MAIN STREET FRONTAGE  
WILLIAMSVILLE CEMETERY  
WILLIAMSVILLE, NEW YORK**

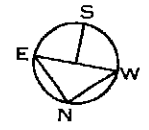

SCALE: 1"=20'-0"

REVISIONS	DATE	BY	DESCRIPTION
1	07-07-07	DM	NEW PLAN
2	07-10-07	DM	REVISED
3	08-16-08	DM	REVISED
4	08-20-08	DM	REVISED
5	03-17-08	DM	REVISED

DRAWN BY: MAS  
CHECKED BY: DM, JMW

GREVER & WARD, INC.  
CEMETERY PLANNING  
3802 N. BUFFALO STREET  
ORCHARD PARK, N.Y. 14127  
716-662-7700